

vtech®

Instruction Manual

Walk & Woof Puppy



VTech understands that a child's needs and abilities change as they grow and with that in mind we develop our toys to teach and entertain at just the right level...

vtech Baby

Toys that will stimulate their interest in different textures, sounds and colours

I am...

...responding to colours, sounds and textures

...understanding cause and effect

...learning to touch, reach, grasp, sit-up, crawl and toddle

Birth-36 months



Pre-School

Interactive toys to develop their imagination and encourage language development

I want...

...to get ready for school by starting to learn the alphabet and counting

...my learning to be as fun, easy and exciting as can be

...to show my creativity with drawing and music so my whole brain develops

3-6 years



Electronic Learning Computers

Cool, aspirational and inspiring computers for curriculum related learning

I need...

...challenging activities that can keep pace with my growing mind

...intelligent technology that adapts to my level of learning

...National Curriculum based content to support what I'm learning at school

4-10 years



To learn more about this and other VTech® products, visit www.vtech.co.uk

INTRODUCTION

Thank you for purchasing the **Walk & Woof Puppy** toy!
This playful interactive puppy loves to follow you around. Pull the puppy along or press the buttons to hear letters, parts of the body, and to listen to music.

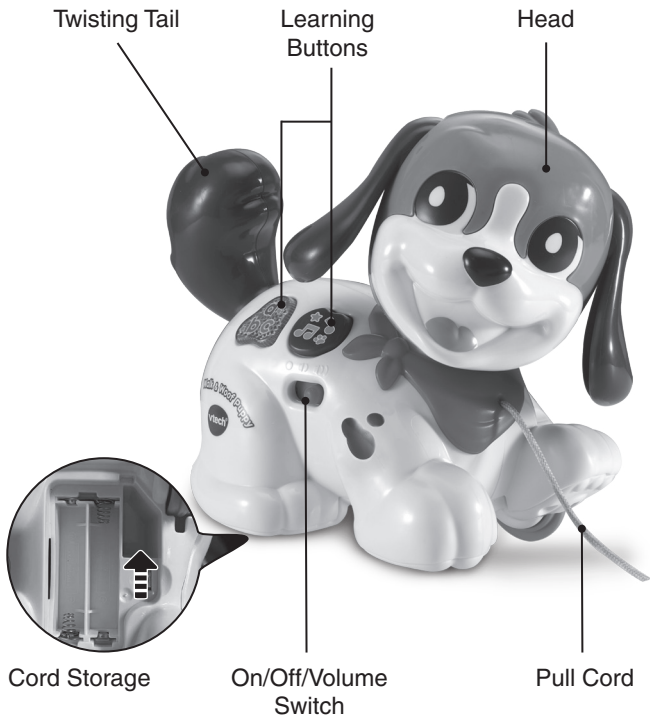

INCLUDED IN THE PACKAGE

- Walk & Woof Puppy
- Quick Start Guide

WARNING

All packing materials such as tape, plastic sheets, packaging locks, removable tags, cable ties, cords and packaging screws are not part of this toy, and should be discarded for your child's safety.

NOTE

Please save this Instruction Manual as it contains important information.

Unlock the Packaging Locks

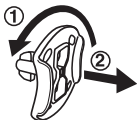

- ① Rotate the packaging lock 90 degrees anticlockwise.
- ② Pull out the packaging locks and discard.

GETTING STARTED

Battery Removal and Installation

1. Make sure the unit is turned **Off**.
2. Find the battery cover on the bottom of the unit, use a screwdriver to loosen the screw, and then open the battery cover.
3. Remove old batteries by pulling up on one end of each battery.
4. Install 2 new AAA (AM-4/LR03) batteries following the diagram inside the battery box. (For best performance, alkaline batteries or fully charged Ni-MH rechargeable batteries are recommended).
5. Replace the battery cover and tighten the screw to secure.

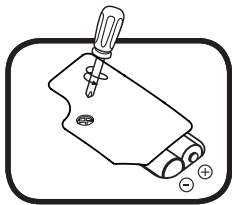

WARNING:

Adult assembly required for battery installation.
Keep batteries out of reach of children.

IMPORTANT: BATTERY INFORMATION

- Insert batteries with the correct polarity (+ and -).
- Do not mix old and new batteries.
- Do not mix alkaline, standard (carbon-zinc) or rechargeable batteries.
- Only batteries of the same or equivalent type as recommended are to be used.
- Do not short-circuit the supply terminals.
- Remove batteries during long periods of non-use.
- Remove exhausted batteries from the toy.
- Dispose of batteries safely. Do not dispose of batteries in fire.

RECHARGEABLE BATTERIES:

- Remove rechargeable batteries (if removable) from toy before charging.
- Rechargeable batteries are only to be charged under adult supervision.
- Do not charge non-rechargeable batteries.

Disposal of batteries and product



The crossed-out wheellie bin symbols on products and batteries, or on their respective packaging, indicates they must not be disposed of in domestic waste as they contain substances that can be damaging to the environment and human health.



The chemical symbols Hg, Cd or Pb, where marked, indicate that the battery contains more than the specified value of mercury (Hg), cadmium (Cd) or lead (Pb) set out in the Batteries and Accumulators Regulation.

The solid bar indicates that the product was placed on the market after 13th August, 2005.

 Please dispose of your product and batteries responsibly.

In the UK, give this toy a second life by disposing of it at a small electricals collection point* so all of its materials can be recycled.

Learn more at:



www.vtech.co.uk/recycle

www.vtech.com.au/sustainability

* Visit www.recyclenow.com to see a list of collection points near you.

PRODUCT FEATURES

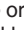
1. On/Off/Volume Switch

To turn the unit **On**, slide the **On/Off/Volume Switch** to the Low volume  or High volume  position. You will hear a sound, phrases and a song. To turn the unit **Off**, slide the **On/Off/Volume Switch** to the **Off**  position.

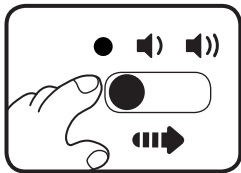

2. Pull Cord Storage

To change puppy from a pull toy to a push toy, store the pull cord by opening the battery compartment and tucking the cord inside. To use as a pull toy again, open the battery compartment and extend the cord. Lay the cord in the notch and close the battery compartment. For your child's safety, we suggest you store the pull cord in the compartment until your child is walking and to supervise your child when playing with the pull cord.

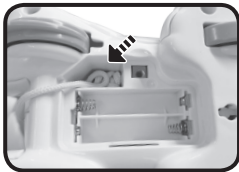

3. Automatic Shut-Off

To preserve battery life, the **Walk & Woof Puppy** will automatically shut off after approximately 65 seconds without input. The puppy can be turned on again by pressing any button.

NOTE

If the unit powers down or if the light fades out during play, please install a new set of batteries.

ACTIVITIES

1. Learning Buttons

Press the **Learning Buttons** to learn letters, puppy facts and songs, you will also hear melodies and sounds. The light will flash with the sounds.



2. Pat the Puppy

Press the puppy's **Head** to hear cute sounds and phrases. The light will flash with the sounds, and the ears will move up and down.

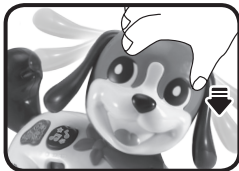

3. Pull Along

Pull the puppy to hear fun sounds and phrases to encourage play. The light will flash with the sounds.



4. Twisting Tail

Twist the tail for manipulative fun!



MELODIES

1. While Strolling Through the Park
2. The Green Grass Grew All Around
3. Where Has My Little Dog Gone?
4. Skip to My Lou
5. Polly Put the Kettle on
6. Humpty, Dumpty
7. For He's a Jolly Good Fellow
8. On Top of Old Smokey
9. Aiken Drum
10. Diddle, Diddle, Dumpling
11. One, Two, Buckle My Shoe
12. Toyland

SONG LYRICS

Song 1

I'm a puppy, and I like to play.
I walk and run and sleep all day.
Woof, woof, woof, woof, woof.
Woof, woof, woof, woof, woof.
Woof, woof, woof, woof, woof.
I'm ready to go for a walk with you!

Song 2

A B C D E F G,
H I J K L M N O P.
Q R S T U V,
W X Y and Z.
Now I know my ABCs,
Next time won't you sing with me!

Song 3

I love to play with you every day.
We can play fetch or go for a walk.
When we get tired, we can take a nap.
Wherever you go, I wanna be with you.

Song 4

D is for dog.
Duh-duh-duh-dog.
D is for dog. I'm your dog!

Song 5

When we play, I wag my tail,
Wag, wag, wag, wag my tail.
When we play, I wag my tail,
I feel so happy!

CARE & MAINTENANCE

1. Keep the unit clean by wiping it with a slightly damp cloth.
2. Keep the unit out of direct sunlight and away from any direct heat sources.
3. Remove the batteries if the unit will not be in use for an extended period of time.
4. Do not drop the unit on hard surfaces and do not expose the unit to moisture or water.

TROUBLESHOOTING

If for some reason the program/activity stops working or malfunctions, please follow these steps:

1. Please turn the unit **Off**.
2. Interrupt the power supply by removing the batteries.
3. Let the unit stand for a few minutes, then replace the batteries.
4. Turn the unit **On**. The unit should now be ready to play with again.
5. If the unit still does not work, install a new set of batteries.

If the problem persists, please contact our Consumer Services Department and a service representative will be happy to help you

CONSUMER SERVICES

Creating and developing **VTech®** products is accompanied by a responsibility that we at **VTech®** take very seriously. We make every effort to ensure the accuracy of the information, which forms the value of our products. However, errors sometimes can occur. It is important for you to know that we stand behind our products and encourage you to call our Consumer Services Department with any problems and/or suggestions that you might have. A service representative will be happy to help you.

UK Customers:

Phone: 0330 678 0149 (from UK) or +44 330 678 0149 (outside UK)
Website: www.vtech.co.uk/support

Australian Customers:

Phone: 1800 862 155
Website: support.vtech.com.au

NZ Customers:

Phone: 0800 400 785
Website: support.vtech.com.au

PRODUCT WARRANTY/ CONSUMER GUARANTEES

UK Customers:

Read our complete warranty policy online at vtech.co.uk/warranty.

Australian Customers:

**VTECH ELECTRONICS (AUSTRALIA) PTY LIMITED –
CONSUMER GUARANTEES**

Under the Australian Consumer Law, a number of consumer guarantees apply to goods and services supplied by VTech Electronics (Australia) Pty Limited. Please refer to vtech.com.au/consumerguarantees for further information.

**Visit our website for more
information about our products,
downloads, resources and more.**

www.vtech.co.uk
www.vtech.com.au

